



TREND CONNECTION

ZOMAYA

8 LASSO ROAD,
GREGORY HILLS, NSW

DA
2022.08.18

Stantec Project Number: 301350465

DRAWING LIST	
NO.	DRAWING NAME
CI-000-001	COVER SHEET, DRAWING REGISTRY AND LOCALITY PLAN
CI-007-001	GENERAL NOTES
CI-070-001	EROSION AND SEDIMENTCONTROL PLAN
CI-076-001	EROSION AND SEDIMENTCONTROL DETAILS
CI-100-001	BULK EARTHWORKSPLAN
CI-501-001	MUSIC MODEL & CATCHMENT PLAN
CI-520-001	STORMWATER DRAINAGE PLAN - GROUND
CI-520-002	STORMWATER DRAINAGE PLAN - BASEMENT LEVEL 1
CI-520-003	STORMWATER DRAINAGE PLAN - BASEMENT LEVEL 2
CI-526-001	STORMWATER DRAINAGE DETAILS - SHEET 1
CI-526-002	STORMWATER DRAINAGE DETAILS - SHEET 2
CI-526-003	STORMWATER DRAINAGE DETAILS - SHEET 3
CI-526-011	CIVIL DETAILS - SHEET 1



The professional's seal on the cover sheet represents that the information on the cover sheet is accurate in designer's professional opinion but does not assume professional responsibility for documents sealed by others that are referenced on the cover sheet. All professionals sealing drawings as a part of the design are professionally responsible for their own sealed documents.

BULK EARTHWORKS NOTES

1. THE EXISTING SITE CONDITIONS SHOWN ON THE FOLLOWING DRAWINGS HAVE INTO CONSIDERATION THE TOPOGRAPHIC SURVEY RECEIVED ON 15/11/2021 PREPARED BY ASPECT DEVELOPMENT & SURVEY SURVEYORS, REFERENCE '1184' DATED 14/05/21.
2. THE INFORMATION IS SHOWN TO PROVIDE A BASIS FOR DESIGN. STANTEC DOES NOT GUARANTEE THE ACCURACY OR COMPLETENESS OF THE SURVEY BASE OR ITS SUITABILITY AS A BASIS FOR CONSTRUCTION DRAWINGS. SHOULD DISCREPANCIES BE ENCOUNTERED DURING CONSTRUCTION BETWEEN THE SURVEY DATA AND ACTUAL FIELD DATA, CONTACT STANTEC ENGINEERS.

OTHER MATTERS

10. STOCKPILES WILL NOT BE LOCATED WITHIN 2 METRES OF HAZARD AREAS INCLUDING LIKELY AREAS OF CONCENTRATED OR HIGH VELOCITY FLOWS SUCH AS WATERWAYS. WHERE THEY ARE BETWEEN 2 AND 5 METRES FROM SUCH AREAS, SPECIAL SEDIMENT CONTROL MEASURES SHOULD BE TAKEN TO MINIMISE POSSIBLE POLLUTION TO DOWNLOUSE WATERS, E.G. THROUGH INSTALLATION OF SEDIMENT FENCING.
11. ANY SAND USED IN THE CONCRETE CURING PROCESS (SPREAD OVER THE SURFACE) WILL BE REMOVED AS SOON AS POSSIBLE AND WITHIN 10 WORKING DAYS FROM PLACEMENT.
12. WATER WILL BE PREVENTED FROM ENTERING THE PERMANENT DRAINAGE SYSTEM UNLESS IT IS RELATIVELY SEDIMENT FREE, I.E. THE CATCHMENT AREA HAS BEEN PERMANENTLY LANDSCAPED AND/OR ANY LIKELY SEDIMENT HAS BEEN FILTERED THROUGH AN APPROVED STRUCTURE.
13. TEMPORARY SOIL AND WATER MANAGEMENT STRUCTURES WILL BE REMOVED ONLY AFTER THE LANDS THEY ARE PROTECTING ARE REHABILITATED.

13. ACCEPTABLE RECEPTORS WILL BE PROVIDED FOR CONCRETE AND MORTAR SPLATTERS, PAINTS, ACID WASHINGS, LIGHT-WEIGHT WASTE MATERIALS AND LITTER.
14. ANY EXISTING TREES WHICH FORM PART OF THE FINAL LANDSCAPING PLAN WILL BE PROTECTED FROM CONSTRUCTION ACTIVITIES BY:
 - 14.1. PROTECTING THEM WITH BARRIER FENCING OR SIMILAR MATERIALS INSTALLED OUTSIDE THE DRIP LINE
 - 14.2. ENSURING THAT NOTHING IS NAILED TO THEM
 - 14.3. PROHIBITING PAVING, GRADING, SEDIMENT WASH OR PLACING OF STOCKPILES WITHIN THE DRIP LINE EXCEPT UNDER THE FOLLOWING CONDITIONS:
 - 14.4. ENCROACHMENT ONLY OCCURS ON ONE SIDE AND NO CLOSER TO THE TRUNK THAN EITHER 1.5 METRES OR HALF THE DISTANCE BETWEEN THE OUTER EDGE OF THE DRIP LINE AND THE TRUNK, WHICH EVER IS THE GREATER
 - 14.5. A DRAINAGE SYSTEM THAT ALLOWS AIR AND WATER TO CIRCULATE THROUGH THE ROOT ZONE (E.G. A GRAVEL BED) IS PLACED UNDER ALL FILL LAYERS OF MORE THAN 300 MILLIMETRES DEPTH
- 14.6. CARE IS TAKEN NOT TO CUT ROOTS UNNECESSARILY NOR TO COMPACT THE SOIL AROUND THEM.

TELSTRA'S PLANS SHOW ONLY THE PRESENCE OF CABLES AND PLANT. THEY ONLY SHOW THEIR POSITION RELATIVE TO ROAD BOUNDARIES, PROPERTY FENCES ETC. AT THE TIME OF INSTALLATION AND TELSTRA DOES NOT WARRANT OR HOLD OUT THAT SUCH PLANS ARE ACCURATE THEREAFTER DUE TO CHANGES THAT MAY OCCUR OVER TIME. DO NOT ASSUME DEPTH OR ALIGNMENT OF CABLES OR PLANT AS THESE VARY SIGNIFICANTLY. THE CONTRACTOR HAS A DUTY OF CARE WHEN EXCAVATING NEAR TELSTRA CABLES AND PLANT. BEFORE USING MACHINE EXCAVATORS TELSTRA PLANT MUST FIRST BE PHYSICALLY EXPOSED BY SOFT DIG POTHOLING TO IDENTIFY ITS LOCATION TELSTRA WILL SEEK COMPENSATION FOR DAMAGES CAUSED TO ITS PROPERTY AND LOSSES CAUSED TO TELSTRA AND ITS CUSTOMERS.

The Copyrights to all designs and drawings are the property of Stantec. Reproduction or use for any purpose other than that authorised by Stantec is forbidden.
The Contractor shall verify and be responsible for all dimensions. DO NOT scale the drawing - any errors or omissions shall be reported to Stantec without delay.

TREND CONNECTION
HOMES

TREND CONNECTION

ZOMAYA

8 LASSO ROAD, GREGORY HILLS, NSW

File Name: 301350465-CI-007-001.DWG

CPO	MDR	RET	2021.11.25
Dwn.	Dsgn.	Chkd.	YYYY.MM.DD

GENERAL NOTES

Project No.
301350465

Revision
B

Drawing No.

Scale
1:1000

CI-007-001

Notes

Issue Status

PRELIMINARY

NOT FOR CONSTRUCTION

This document is suitable only for the purpose noted above.
Use of this document for any other purpose is not permitted.

B	ISSUE FOR DA	CPO	MMM	2022.03.11
A	DRAFT FOR COORDINATION	CPO	MDR	2021.11.25
Issued/Revision		By	Appd	YYYY.MM.DD

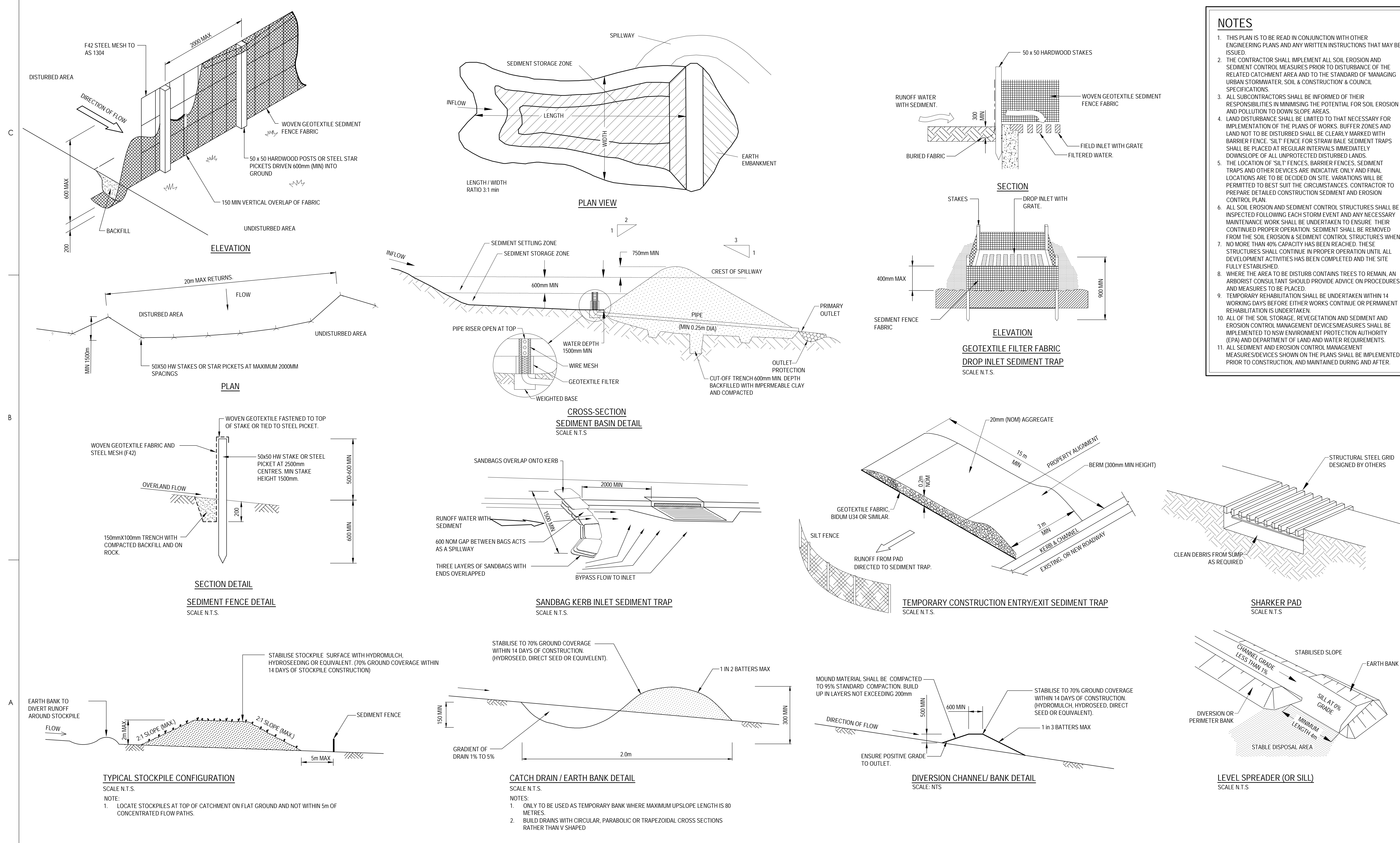

Notes																																																																																																																																																																																																																																																																																																																																																																																																																																																																																																																																																																																																																																																																																																																																																																																																																																																																																																																																																																																																																																																																																																																																																																																																																																																																																																																																																																																																																																																									</
-------	--	--	--	--	--	--	--	--	--	--	--	--	--	--	--	--	--	--	--	--	--	--	--	--	--	--	--	--	--	--	--	--	--	--	--	--	--	--	--	--	--	--	--	--	--	--	--	--	--	--	--	--	--	--	--	--	--	--	--	--	--	--	--	--	--	--	--	--	--	--	--	--	--	--	--	--	--	--	--	--	--	--	--	--	--	--	--	--	--	--	--	--	--	--	--	--	--	--	--	--	--	--	--	--	--	--	--	--	--	--	--	--	--	--	--	--	--	--	--	--	--	--	--	--	--	--	--	--	--	--	--	--	--	--	--	--	--	--	--	--	--	--	--	--	--	--	--	--	--	--	--	--	--	--	--	--	--	--	--	--	--	--	--	--	--	--	--	--	--	--	--	--	--	--	--	--	--	--	--	--	--	--	--	--	--	--	--	--	--	--	--	--	--	--	--	--	--	--	--	--	--	--	--	--	--	--	--	--	--	--	--	--	--	--	--	--	--	--	--	--	--	--	--	--	--	--	--	--	--	--	--	--	--	--	--	--	--	--	--	--	--	--	--	--	--	--	--	--	--	--	--	--	--	--	--	--	--	--	--	--	--	--	--	--	--	--	--	--	--	--	--	--	--	--	--	--	--	--	--	--	--	--	--	--	--	--	--	--	--	--	--	--	--	--	--	--	--	--	--	--	--	--	--	--	--	--	--	--	--	--	--	--	--	--	--	--	--	--	--	--	--	--	--	--	--	--	--	--	--	--	--	--	--	--	--	--	--	--	--	--	--	--	--	--	--	--	--	--	--	--	--	--	--	--	--	--	--	--	--	--	--	--	--	--	--	--	--	--	--	--	--	--	--	--	--	--	--	--	--	--	--	--	--	--	--	--	--	--	--	--	--	--	--	--	--	--	--	--	--	--	--	--	--	--	--	--	--	--	--	--	--	--	--	--	--	--	--	--	--	--	--	--	--	--	--	--	--	--	--	--	--	--	--	--	--	--	--	--	--	--	--	--	--	--	--	--	--	--	--	--	--	--	--	--	--	--	--	--	--	--	--	--	--	--	--	--	--	--	--	--	--	--	--	--	--	--	--	--	--	--	--	--	--	--	--	--	--	--	--	--	--	--	--	--	--	--	--	--	--	--	--	--	--	--	--	--	--	--	--	--	--	--	--	--	--	--	--	--	--	--	--	--	--	--	--	--	--	--	--	--	--	--	--	--	--	--	--	--	--	--	--	--	--	--	--	--	--	--	--	--	--	--	--	--	--	--	--	--	--	--	--	--	--	--	--	--	--	--	--	--	--	--	--	--	--	--	--	--	--	--	--	--	--	--	--	--	--	--	--	--	--	--	--	--	--	--	--	--	--	--	--	--	--	--	--	--	--	--	--	--	--	--	--	--	--	--	--	--	--	--	--	--	--	--	--	--	--	--	--	--	--	--	--	--	--	--	--	--	--	--	--	--	--	--	--	--	--	--	--	--	--	--	--	--	--	--	--	--	--	--	--	--	--	--	--	--	--	--	--	--	--	--	--	--	--	--	--	--	--	--	--	--	--	--	--	--	--	--	--	--	--	--	--	--	--	--	--	--	--	--	--	--	--	--	--	--	--	--	--	--	--	--	--	--	--	--	--	--	--	--	--	--	--	--	--	--	--	--	--	--	--	--	--	--	--	--	--	--	--	--	--	--	--	--	--	--	--	--	--	--	--	--	--	--	--	--	--	--	--	--	--	--	--	--	--	--	--	--	--	--	--	--	--	--	--	--	--	--	--	--	--	--	--	--	--	--	--	--	--	--	--	--	--	--	--	--	--	--	--	--	--	--	--	--	--	--	--	--	--	--	--	--	--	--	--	--	--	--	--	--	--	--	--	--	--	--	--	--	--	--	--	--	--	--	--	--	--	--	--	--	--	--	--	--	--	--	--	--	--	--	--	--	--	--	--	--	--	--	--	--	--	--	--	--	--	--	--	--	--	--	--	--	--	--	--	--	--	--	--	--	--	--	--	--	--	--	--	--	--	--	--	--	--	--	--	--	--	--	--	--	--	--	--	--	--	--	--	--	--	--	--	--	--	--	--	--	--	--	--	--	--	--	--	--	--	--	--	--	--	--	--	--	--	--	--	--	--	--	--	--	--	--	--	--	--	--	--	--	--	--	--	--	--	--	--	--	--	--	--	--	--	--	--	--	--	--	--	--	--	--	--	--	--	--	--	--	--	--	--	--	--	--	--	--	--	--	--	--	--	--	--	--	--	--	--	--	--	--	--	--	--	--	--	--	--	--	--	--	--	--	--	--	--	--	--	--	--	--	--	--	--	--	--	--	--	--	--	--	--	--	--	--	--	--	--	--	--	--	--	--	--	--	--	--	--	--	--	--	--	--	--	--	--	--	--	--	--	--	--	--	--	--	--	--	--	--	--	--	--	--	--	--	--	--	--	--	--	--	--	--	--	--	--	--	--	--	--	--	--	--	--	--	--	--	--	--	--	--	--	--	--	--	--	--	--	--	--	--	--	--	--	--	--	--	--	--	--	--	--	--	--	--	--	--	--	--	--	--	--	--	--	--	--	--	--	--	--	--	--	--	--	--	--	--	--	--	--	--	--	--	--	--	--	--	--	--	--	--	--	--	--	--	--	--	--	--	--	--	--	--	--	--	--	--	--	--	--	--	--	--	--	--	--	--	--	--	--	--	--	--	--	--	--	--	--	--	--	--	--	--	--	--	--	--	--	--	--	--	--	--	--	--	--	--	--	--	--	--	--	--	--	--	--	--	--	--	--	--	--	--	--	--	--	--	--	--	--	--	--	--	--	--	--	--	--	--	--	--	--	--	--	--	--	--	--	--	--	--	--	--	--	--	--	--	--	--	--	--	--	--	--	--	--	--	--	--	--	--	--	--	--	--	--	--	--	--	--	--	--	--	--	--	--	--	--	--	--	--	--	--	--	--	--	--	--	--	--	--	--	--	--	--	--	--	--	--	--	--	--	--	--	--	--	--	--	--	--	--	--	--	--	--	--	--	--	--	--	--	--	--	--	--	--	--	--	--	--	--	--	--	--	--	--	--	--	--	--	--	--	--	--	--	--	--	--	--	--	--	--	--	--	--	--	--	--	--	--	--	--	--	--	--	--	--	--	--	--	--	--	--	--	--	--	--	--	--	--	--	--	--	----

LASSO ROAD

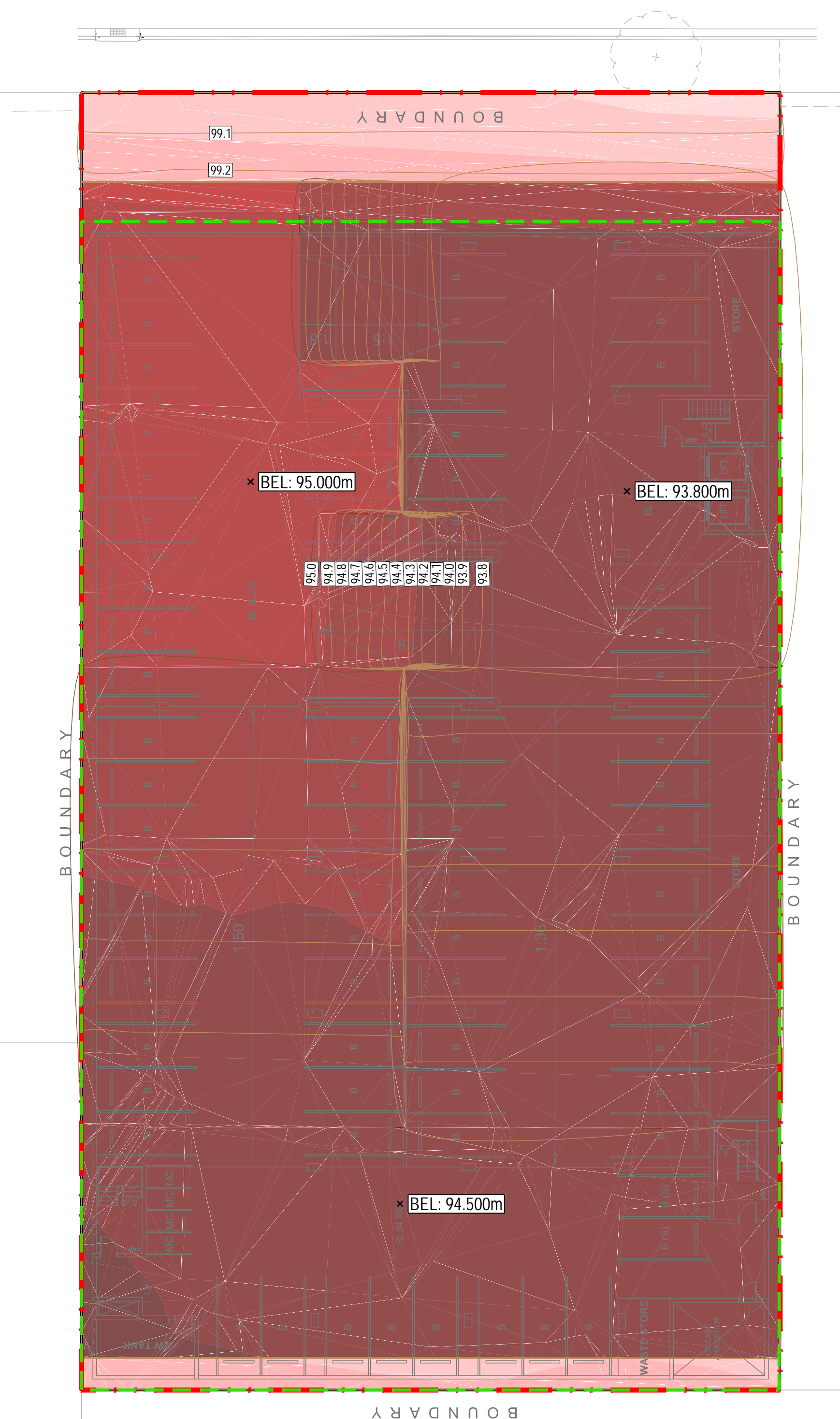

LEGEND



















-
- Legend for Figure 10:
- PROPOSED SITE BOUNDARY (Red dashed line)
 - LIMIT OF WORKS BOUNDARY (Green dashed line)
 - BULK EARTHWORKS CONTOUR (Brown line with '14.0' label)
 - EXISTING CONTOURS (Grey dashed line with '18.0' label)
 - BEL (Brown line with '14.0' label)
 - BULK EARTHWORKS LEVEL (Grey dashed line with '18.0' label)

NOTES

1. VOLUMES ARE INDICATIVE ONLY AND ARE BASED ON A COMPARISON BETWEEN THE DESIGN SURFACE AND THE SURVEYED SURFACE.
2. NOTE THAT ALL VOLUMES DEPICTED ARE SOLID VOLUMES ONLY AND MAY NOT REFLECT DETAILED EARTHWORKS.
3. NO ALLOWANCE HAS BEEN MADE FOR BULKING FACTORS.
4. NO ALLOWANCE HAS BEEN MADE FOR DETAILED EARTHWORKS; ie OSD TANK, RAINWATER TANK, SERVICE TRENCHING, DETAILED EXCAVATION, FOOTINGS, RETAINING WALLS, PAVEMENT BOXING, BUILDING SLABS AND THE LIKE.
5. THE CONTRACTOR SHALL USE FINAL SURFACE LEVELS AND TYPICAL PAVEMENT DETAILS FOR ACTUAL EARTHWORKS LEVELS.
6. TOPSOIL STRIPPING OF 200mm HAS BEEN ASSUMED FOR THE PURPOSE OF THE BULK EARTHWORKS. REFER GEOTECH REPORT FOR FURTHER INFORMATION.
7. BULK EARTHWORKS CUTOFF VOLUME CONSIDERATIONS:
 - 150mm TOPSOIL HAS BEEN CONSIDERED TO BE REMOVED.
 - 200mm STRUCTURAL SLAB UNDER BUILDING PADS.
 - 200mm THICKNESS FOR TRAFFICABLE PAVEMENT.
8. THE SURVEY SURFACE AS PROVIDED HAS BEEN UTILISED FOR COMPARISON PURPOSES.
9. STANTEC DOES NOT TAKE RESPONSIBILITY FOR ACCURACY OF EXISTING SURVEY.

CUT AND FILL VOLUME:
CUT: 19,050 m³
FILL: 0 m³
NET: 19,050 m³ (CUT)

Surface Analysis: Elevation Ranges

Number	Color	Minimum Elevation (m)	Maximum Elevation (m)	2D Area (m²)
1		-8.500	-8.000	30.1
2		-8.000	-7.500	1715.8
3		-7.500	-7.000	330.1
4		-7.000	-6.500	367.1
5		-6.500	-6.000	15.7
6		-6.000	-5.500	0.2
7		-5.500	-5.000	0.2
8		-5.000	-4.500	0.2
9		-4.500	-4.000	0.2
10		-4.000	-3.500	0.2
11		-3.500	-3.000	0.2
12		-3.000	-2.500	0.2
13		-2.500	-2.000	0.5
14		-2.000	-1.500	113.8
15		-1.500	-1.000	127.5
16		-1.000	-0.500	12.1
17		-0.500	0.000	0.4
18		0.000	0.500	0.0

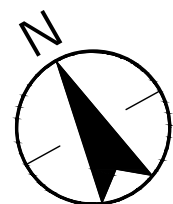

1:200 2 0 2 4 6 8 10 A

1:400 A

Notes:

A	ISSUE FOR DA	JDL	MMM
Issued/Revision		By	Appd
			2022.06.17
			YYYY.MM.DD

Issue Status

PRELIMINARY

NOT FOR CONSTRUCTION

This document is suitable only for the purpose noted above.
Use of this document for any other purpose is not permitted.

Colour Disclaimer

This drawing has been documented in colour. This drawing is required to be printed in colour. Failure to do so may result in loss of information. Black and white printing may be used if specific black and white documents have been obtained from Stantec.

Notes



Stantec Australia Pty. Ltd.
Level 6, Building B
207 Pacific Highway
St Leonards, NSW 2065
Tel: +61 2 8484 7000

Copyright Reserved

The Copyrights to all designs and drawings are the property of Stantec. Reproduction or use for any purpose other than that authorised by Stantec is forbidden.
The Contractor shall verify and be responsible for all dimensions. DO NOT scale the drawing - any errors or omissions shall be reported to Stantec without delay.

Client/Project Logc

TREND CONNECTION
HOMES

Client/Project

TREND CONNECTION

ZOMAYA

8 LASSO ROAD, GREGORY HILLS, NSW

File Name: 301350465-CI-100-001.DWG	CPO	MDR	RET	2022.06.17
	Dwn.	Dsgn.	Chkd.	YYYY.MM.DD

Title

BULK EARTHWORKS PLAN

Project No.
301350465

Scale
1:200

Revision
A

Drawing No.

CI-100-001

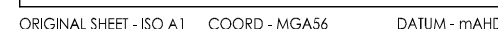

Notes

E	ISSUE FOR REVISED DA	JDL	MMM 2022.08.18
D	ISSUE FOR DA	JDL	MMM 2022.06.21
C	ISSUE FOR DA	JDL	MMM 2022.06.17
B	ISSUE FOR DA	CPO	MMM 2022.03.11
A	DRAFT FOR COORDINATION	CPO	MDR 2021.11.25
Issued/Revision		By	Appd YYYY.MM.DD

Colour Disclaimer

This drawing has been documented in colour. This drawing is required to be printed in colour. Failure to do so may result in loss of information. Black and white printing may be used if specific black and white documents have been obtained from Stantec.



Client/Project Logc

TREND CONNECTION
HOMES

Client/Project

TREND CONNECTION

ZOMAYA

8 LASSO ROAD, GREGORY HILLS, NSW

File Name: 301350465-CI-520-001.DWG	CPO	MDR	RET	2021.11.25
	Dwn.	Dsgn.	Chkd.	YYYY.MM.DD

Title

STORMWATER DRAINAGE PLAN -
GROUND

Project No.
301350465

Revision
F

Scale
1:200

Drawing No.

CI-520-001

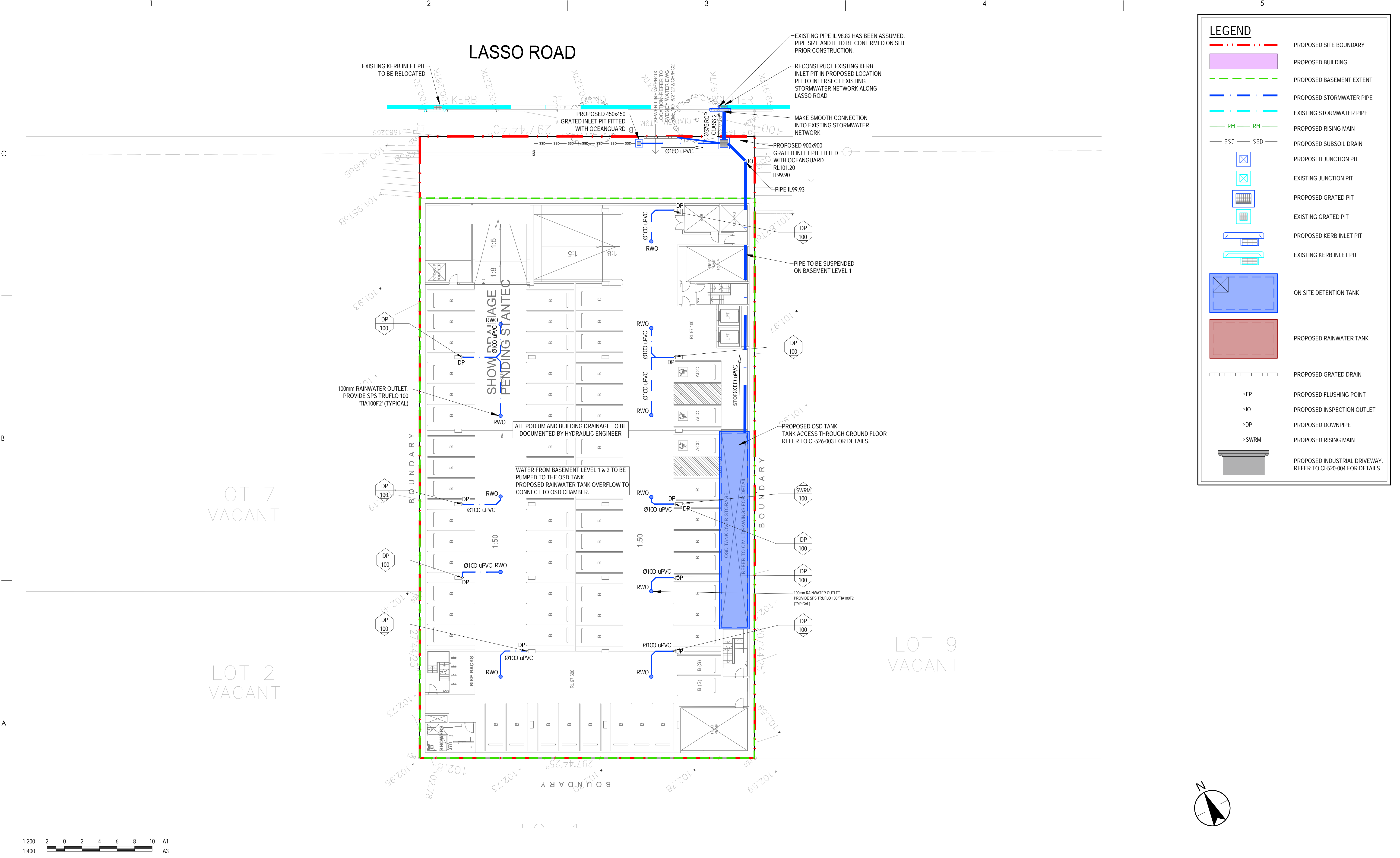

Notes

E	ISSUE FOR REVISED DA	JDL	MMM	2022.08.18
D	ISSUE FOR DA	JDL	MMM	2022.06.21
C	ISSUE FOR DA	JDL	MMM	2022.06.17
B	ISSUE FOR DA	JDL	MMM	2022.03.11
A	DRAFT FOR COORDINATION	CPO	MDR	2021.11.25

Issued/Revision

Issue Status

PRELIMINARY

NOT FOR CONSTRUCTION

This document is suitable only for the purpose noted above. Use of this document for any other purpose is not permitted.

Colour Disclaimer

This drawing has been documented in colour. This drawing is required to be printed in colour. Failure to do so may result in loss of information. Black and white printing may be used if specific black and white documents have been obtained from Stantec.

Notes

Stantec

Stantec Australia Pty. Ltd.
Level 6, Building B
207 Pacific Highway
St Leonards, NSW 2055
Tel: +61 2 8484 7000

Copyright Reserved

The Copyrights to all designs and drawings are the property of Stantec. Reproduction or use for any purpose other than that authorised by Stantec is forbidden. The Contractor shall verify and be responsible for all dimensions. DO NOT scale the drawing - any errors or omissions shall be reported to Stantec without delay.

Client/Project Logo

TREND CONNECTION
HOMES

Client/Project

TREND CONNECTION

ZOMAYA

8 LASSO ROAD, GREGORY HILLS, NSW

File Name: 301350465-CI-520-002.DWG

CPO Dwn.

MDR Dign.

RET Chkd.

2021.11.25

YYYY.MM.DD

Title

STORMWATER DRAINAGE PLAN - BASEMENT LEVEL 1

Project No. 301350465

Scale 1:200

Revision **E**

Drawing No. **CI-520-002**

PROJECT: 17-04-2023 15:40 PM BY: LK/MS/ADJ
P:\301350465\PROJECT DOCUMENTATION\DRAWINGS & DESIGN\SET 1

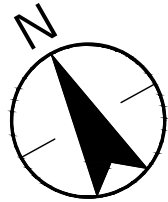

Revision C	Drawing No. CI-520-003
----------------------	----------------------------------

